

Sample Product Specification:
 (We offer ingots with custom set orientation and dimension tolerance)

6" Sapphire Crystal Ingot

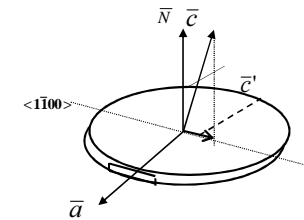

Specification				
	Property	Target	Tolerance	Unit
1	Surface Orientation	C-plane (0001)		
2	M-axis Orientation Tolerance (α)	0.0	± 0.1	degree ($^\circ$)
3	A-axis Orientation Tolerance (β)	0.0	± 0.1	degree ($^\circ$)
4	Primary Flat Orientation	A-plane (11-20)		
5	M-axis Orientation Tolerance (γ)	0.0	± 0.2	degree ($^\circ$)
6	C-axis Orientation Tolerance (β)	0.0	± 0.2	degree ($^\circ$)
7	Flat Length	47,5	$\pm 2,0$	mm
8	Flat Height	-	-	mm
9	Diameter	150,10	± 0.15	mm
10	Usable Ingot Length	> 40	-	mm/core
11	Edge Chipping/Crack	<3mm summation of both ends		
12	Defect (pore, chip, twin, etc)	< 15	-	%/core
13	Face Surface Finish	Find Ground		
14	OD Surface Finish	Find Ground		
15	EPD	$\leq 1,000$	-	pcs/cm ²
16	X-ray rocking curve	≤ 14	-	arcsec

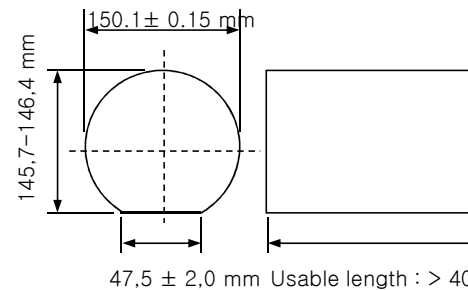
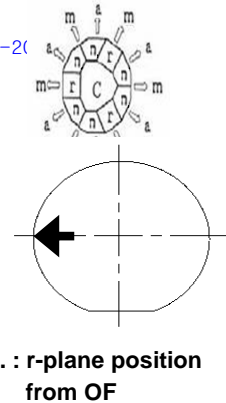
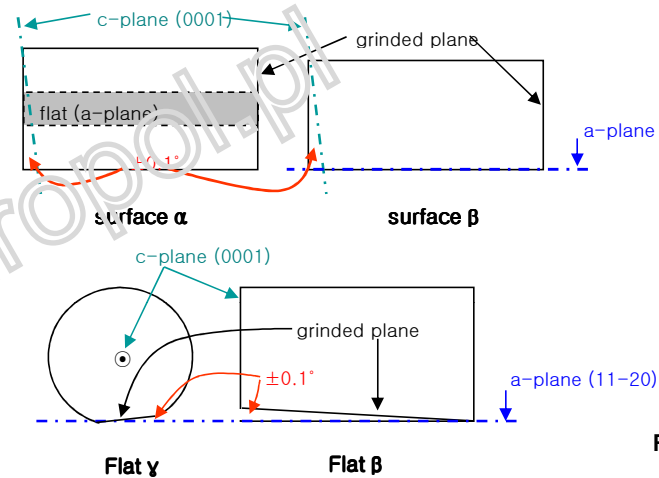

Reference : 6" sapphire ingot

Note

- 1) Bubble spec : None by visual inspection under a high intensity light
- 2) Grain boundary/Lineage spec :
None by visual inspection under polarized light
- 3) Defect areas : Allowance as noted. Defect areas will be identified and marked on individual cores. Defect areas will not be billed.
- 4) Material documentation : A unique and traceable Lot number will be marked and attached specification on each core.